

① PRESENTATION

KAWNEER AN ARCONIC COMPANY

555 Guthridge Ct.
Technology Park/Atlanta
Norcross, GA 30092 USA
Tel: +1 770 449 5555

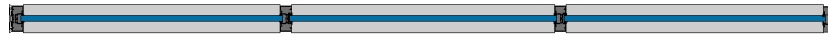

① Basic Wall Example
1 1/2" = 1'-0"



① Section
1 1/2" = 1'-0"

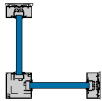

① 90° Outside corner Two Pockets
1 1/2" = 1'-0"

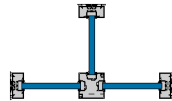

① Corner Post Three Pockets
1 1/2" = 1'-0"

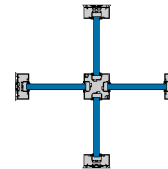

① Corner Post Four Pockets
1 1/2" = 1'-0"



① 135° Outside corner
1 1/2" = 1'-0"

KAWNEER AN ARCONIC COMPANY

555 Guthridge Ct.
Technology Park/Atlanta
Norcross, GA 30092 USA
Tel: + 1 770 449 5555

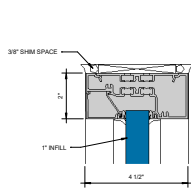

① HEAD
S' = 1'-0"

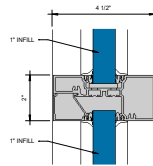

② HORIZONTAL
S' = 1'-0"

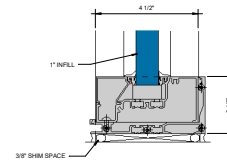

③ SILL WITH SEALANT OPTION
S' = 1'-0"

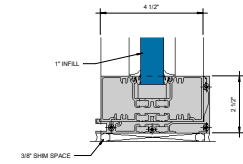

④ SILL WITH SILL FILLER CUP, SEALANT OPTION
S' = 1'-0"

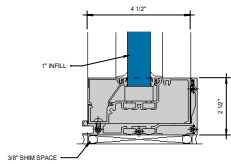

⑤ SILL WITH SEALANT & GASKET OPTION
S' = 1'-0"

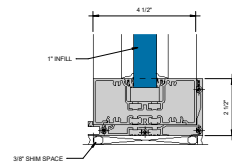

⑥ SILL WITH SILL FILLER CLIP, SEALANT & GASKET OPTION
S' = 1'-0"

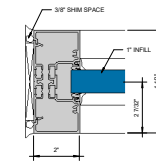

⑦ JAMB
S' = 1'-0"

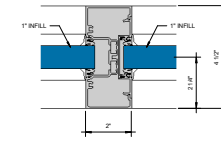

⑧ VERTICAL MULLION
S' = 1'-0"

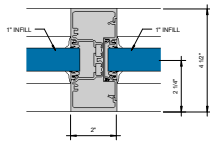

⑨ MEDIUM WEIGHT MULLION
S' = 1'-0"

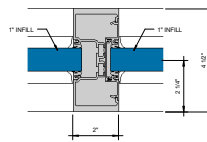

⑩ HEAVY WEIGHT MULLION
S' = 1'-0"

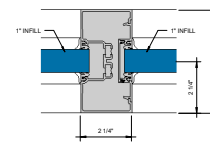

⑪ 2-1/4" VERTICAL MULLION
S' = 1'-0"

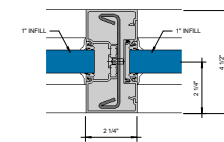

⑫ 2-1/4" VERTICAL MULLION WITH STEEL
S' = 1'-0"

KAWNEER AN ARCONIC COMPANY

555 Guthridge Ct.
Technology Park/Atlanta
Norcross, GA 30092 USA
Tel: + 1 770 449 5555

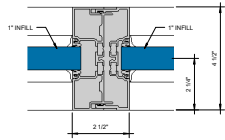

① EXPANSION MULLION
S₁ = 1'-0"

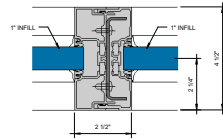

② EXPANSION MULLION WITH STEEL
S₁ = 1'-0"

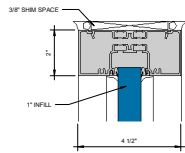

① HEAD
6" = 1'-0"

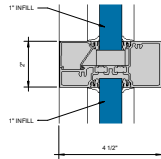

② HORIZONTAL
6" = 1'-0"

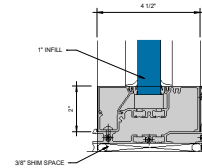

③ SILL WITH SEALANT OPTION
6" = 1'-0"

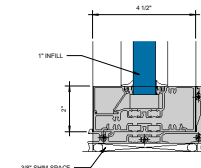

④ SILL WITH SILL FILLER CLIP, SEALANT & GASKET OPTION
6" = 1'-0"

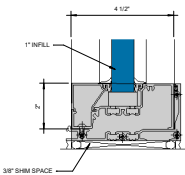

⑤ SILL WITH SEALANT & GASKET OPTION
6" = 1'-0"

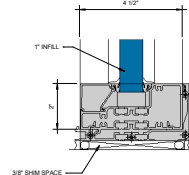

⑥ SILL WITH SILL FILLER CLIP, SEALANT & GASKET OPTION
6" = 1'-0"

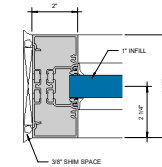

⑦ JAMB
6" = 1'-0"

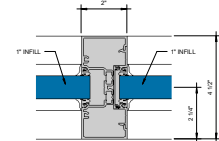

⑧ VERTICAL MULLION
6" = 1'-0"

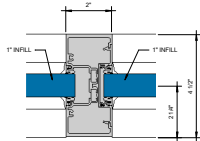

⑨ MEDIUM WEIGHT MULLION
6" = 1'-0"

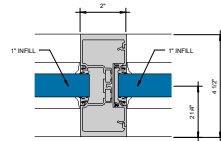

⑩ HEAVY WEIGHT MULLION
6" = 1'-0"

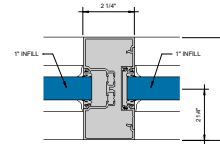

⑪ 2 1/4" VERTICAL MULLION
6" = 1'-0"

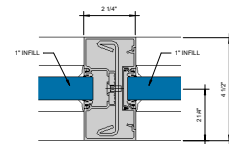

⑫ 2 1/4" VERTICAL MULLION WITH STEEL
6" = 1'-0"

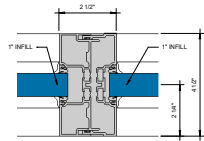

① EXPANSION MULLION
E = 1-0"

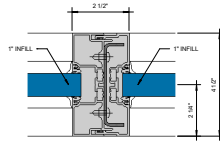

② EXPANSION MULLION WITH STEEL
E = 1-0"

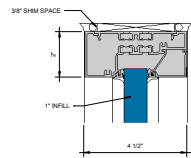

① HEAD
Ø = 1'-0"

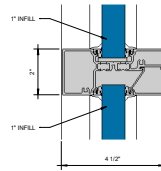

② HORIZONTAL
Ø = 1'-0"

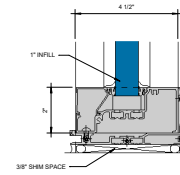

③ SILL WITH SEALANT OPTION
Ø = 1'-0"

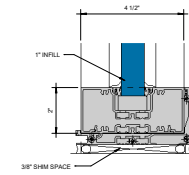

④ SILL WITH SILL FILLER CLIP, SEALANT & GASKET OPTION-3A-3
Ø = 1'-0"

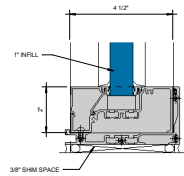

⑤ SILL WITH SEALANT & GASKET OPTION-3B-3
Ø = 1'-0"

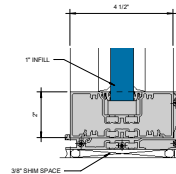

⑥ SILL WITH SILL FILLER CLIP, SEALANT & GASKET OPTION-3C-3
Ø = 1'-0"

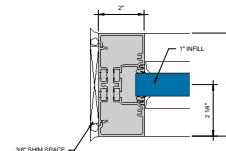

⑦ JAMB
Ø = 1'-0"

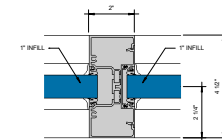

⑧ VERTICAL MULLION
Ø = 1'-0"

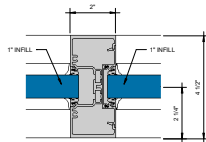

⑨ MEDIUM WEIGHT MULLION
Ø = 1'-0"

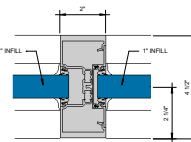

⑩ HEAVY WEIGHT MULLION
Ø = 1'-0"

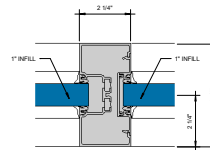

⑪ 2-1/4" VERTICAL MULLION
Ø = 1'-0"

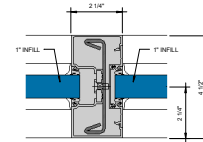

⑫ 2-1/4" VERTICAL MULLION WITH STEEL
Ø = 1'-0"

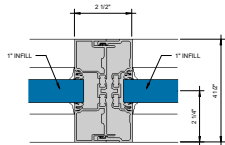

① EXPANSION MULLION
R¹ = 1.0"

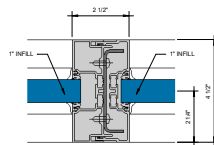

② EXPANSION MULLION WITH STEEL
R¹ = 1.0"

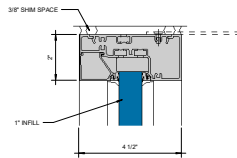

① HEAD W/STRAP ANCHOR
6" = 1'-0"

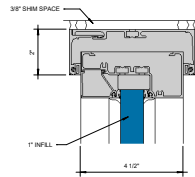

② HEAD W/RECEPTOR
6" = 1'-0"

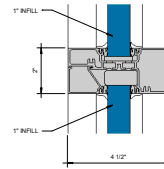

③ HORIZONTAL
6" = 1'-0"

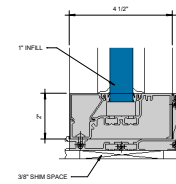

④ SILL WITH SCREW DOWN
6" = 1'-0"

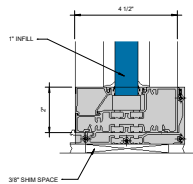

⑤ SILL WITH SILL FILLER CLIP
6" = 1'-0"

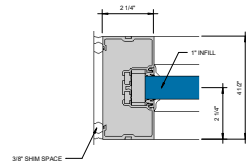

⑥ FIRST BAY JAMB
6" = 1'-0"

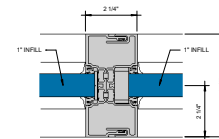

⑦ VERTICAL MULLION
6" = 1'-0"

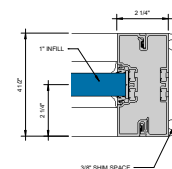

⑧ LAST BAY JAMB
6" = 1'-0"

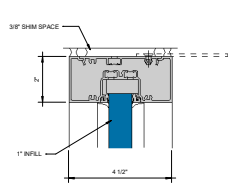

① HEAD W/ STRAP ANCHOR
G = 1'-0"

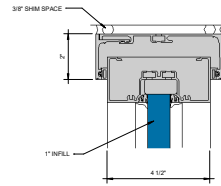

② HEAD W/ RECEPTOR
G = 1'-0"

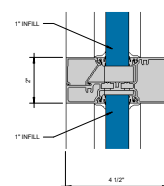

③ HORIZONTAL
G = 1'-0"

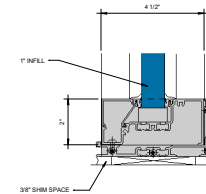

④ SILL WITH SCREW DOWN
G = 1'-0"

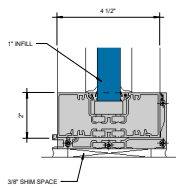

⑤ SILL WITH SILL FILLER CLIP
G = 1'-0"

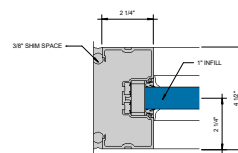

⑥ FIRST BAY JAMB
G = 1'-0"

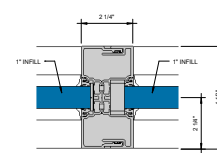

⑦ VERTICAL MULLION
G = 1'-0"

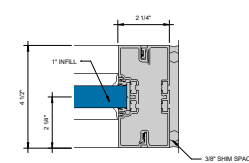

⑧ LAST BAY JAMB
G = 1'-0"

KAWNEER AN ARCONIC COMPANY

555 Guthridge Ct.
Technology Park/Atlanta
Norcross, GA 30092 USA
Tel: + 1 770 449 5555

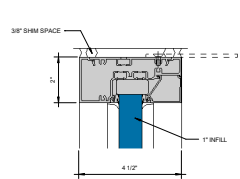

① HEAD W/STRAP ANCHOR
S¹ = 1'-0"

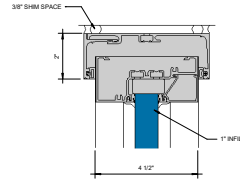

② HEAD WIRE RECEPTOR
S¹ = 1'-0"

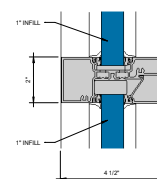

③ HORIZONTAL
S¹ = 1'-0"

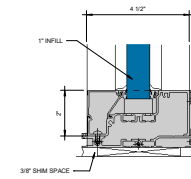

④ SILL WITH SCREW DOWN
S¹ = 1'-0"

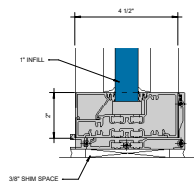

⑤ SILL WITH SILL FILLER CLIP
S¹ = 1'-0"

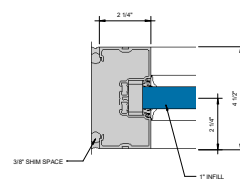

⑥ FIRST BAY JAMB
S¹ = 1'-0"

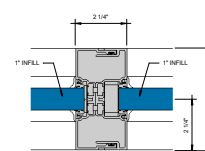

⑦ VERTICAL MULLION
S¹ = 1'-0"

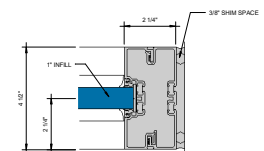

⑧ LAST BAY JAMB
S¹ = 1'-0"

KAWNEER AN ARCONIC COMPANY

555 Guthridge Ct.
Technology Park/Atlanta
Norcross, GA 30092 USA
Tel: + 1 770 449 5555

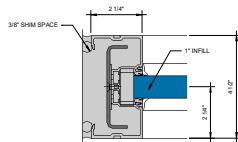

FIRST BAY JAMB WITH STEEL
REINFORCEMENT
① 6" x 1'-0"

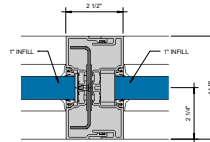

② VERTICAL WITH STEEL
6" x 1'-0"

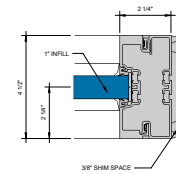

③ LAST BAY JAMB W/ STEEL
6" x 1'-0"

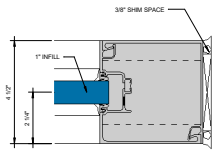

CORNER POST AT JAMB WITH ONE
POCKET DETAIL
Ø = 1-0"

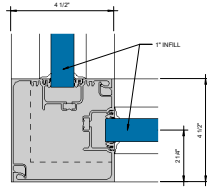

90° OUTSIDE CORNER TWO POCKETS
Ø = 1-0"

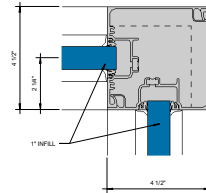

90° INSIDE CORNER TWO POCKETS
Ø = 1-0"

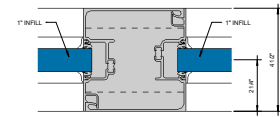

CORNER POST TWO POCKETS
Ø = 1-0"

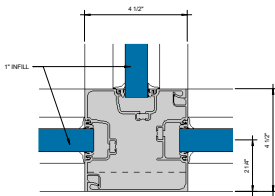

CORNER POST THREE POCKETS
Ø = 1-0"

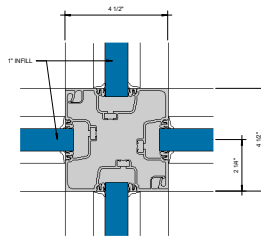

CORNER POST FOUR POCKETS
Ø = 1-0"

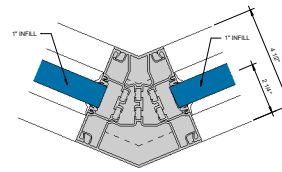

135° OUTSIDE CORNER
Ø = 1-0"

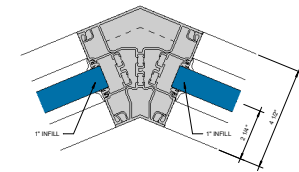

135° INSIDE CORNER
Ø = 1-0"

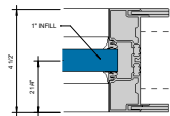

VARIABLE BRAKE METAL CORNER
Ø = 1-0"

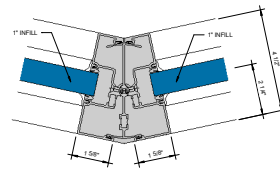

ADJUSTABLE PIVOT OUTSIDE CORNER
Ø = 1-0"

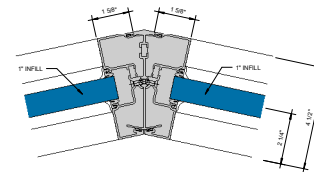

ADJUSTABLE PIVOT INSIDE CORNER
Ø = 1-0"

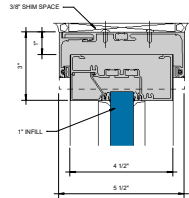

COMPENSATING RECEPTOR FOR
OUTSIDE GLAZED HEAD
① $\frac{1}{2}''$

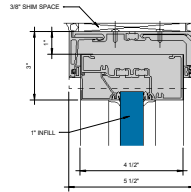

HW COMPENSATING RECEPTOR FOR
OUTSIDE GLAZED HEAD
② $\frac{1}{2}''$

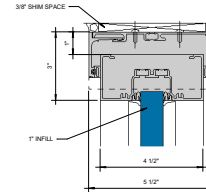

COMPENSATING RECEPTOR FOR
OUTSIDE GLAZED HEAD GLASS STOPS
③ $\frac{1}{2}''$

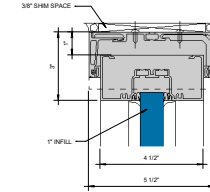

HW COMPENSATING RECEPTOR FOR
OUTSIDE GLAZED HEAD GLASS STOPS
④ $\frac{1}{2}''$

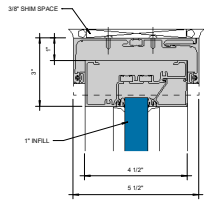

COMPENSATING RECEPTOR FOR
INSIDE GLAZED HEAD
⑤ $\frac{1}{2}''$

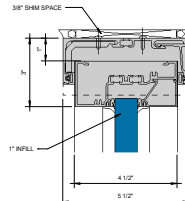

HW COMPENSATING RECEPTOR FOR
INSIDE GLAZED HEAD
⑥ $\frac{1}{2}''$

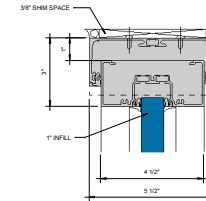

ONE PIECE COMPENSATING RECEPTOR
FOR OUTSIDE GLAZED HEAD GLASS
⑦ STOPS "UP"
⑧ $\frac{1}{2}''$

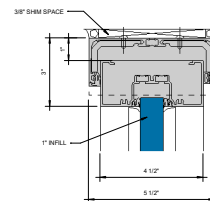

HW ONE PIECE COMPENSATING HEAD
RECEPTOR FOR OUTSIDE GLAZED
HEAD GLASS STOPS "UP"
⑨ $\frac{1}{2}''$

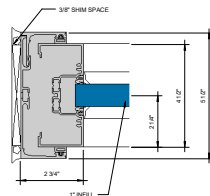

COMPENSATING RECEPTOR FOR
OUTSIDE GLAZED JAMB
⑩ $\frac{1}{2}''$

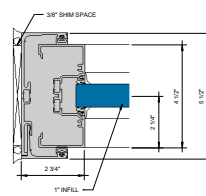

COMPENSATING RECEPTOR FOR
OUTSIDE GLAZED JAMB
⑪ $\frac{1}{2}''$

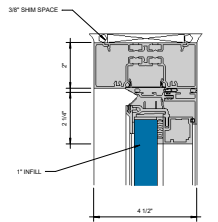

① HEAD CASEMENT OUTSWING
6" = 1'-0"

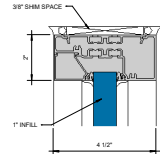

② HEAD
6" = 1'-0"

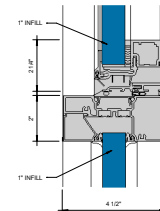

③ CASEMENT OUTSWING
6" = 1'-0"

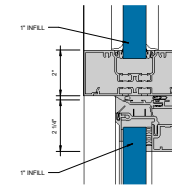

④ PROJECT OUT
6" = 1'-0"

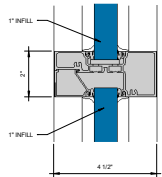

⑤ HORIZONTAL
6" = 1'-0"

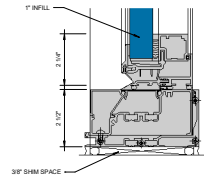

PROJECT OUT - SILL WITH SEALANT
⑥ OPTION
6" = 1'-0"

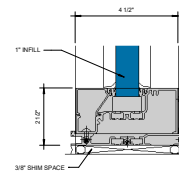

⑦ SILL WITH SEALANT OPTION
6" = 1'-0"

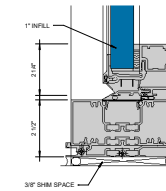

PROJECT OUT - SILL WITH SEALANT
⑧ OPTION & SILL FILLER CLIP
6" = 1'-0"

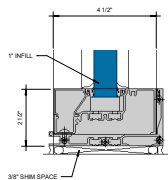

SILL WITH SEALANT AND GASKET
⑨ OPTION
6" = 1'-0"

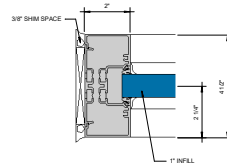

⑩ JAMB
6" = 1'-0"

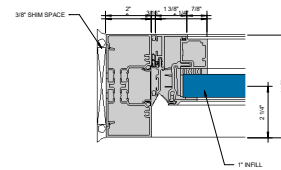

⑪ CASEMENT OUTSWING
6" = 1'-0"

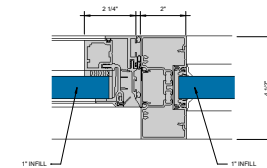

⑫ CASEMENT OUTSWING
6" = 1'-0"

KAWNEER AN ARCONIC COMPANY

555 Guthridge Ct.
Technology Park/Atlanta
Norcross, GA 30092 USA
Tel: +1 770 449 5555

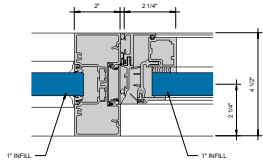

PROJECT OUT
5" = 1"

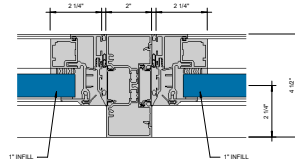

PROJECT OUT
5" = 1"

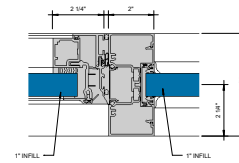

PROJECT OUT
5" = 1"

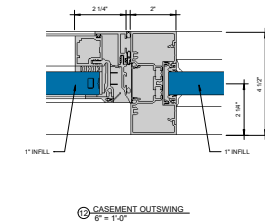
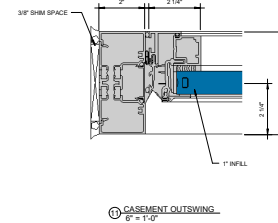
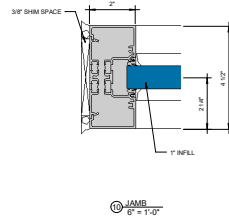
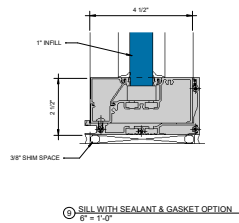
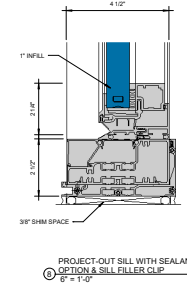
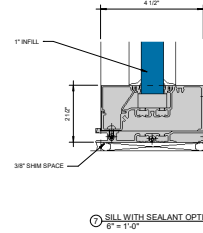
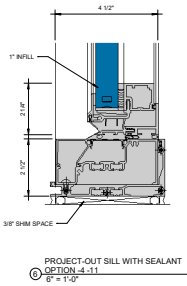
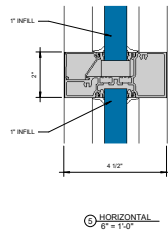
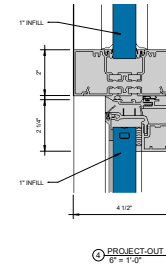
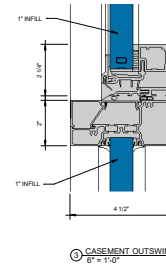
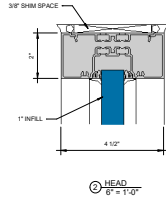
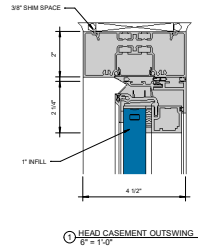

Kawneer

Trifab™ 451UT Framing System - GLASSvent UT Windows Details - Center Set - Outside Glazed - Optional Glass Stops “Up” - 1" Infill

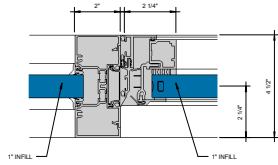

PROJECT OUT
2" = 1'-0"

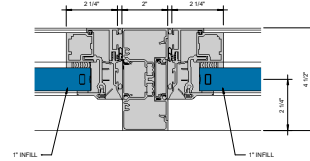

PROJECT OUT
2" = 1'-0"

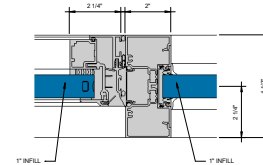

PROJECT OUT
2" = 1'-0"

KAWNEER AN ARCONIC COMPANY

555 Guthridge Ct.
Technology Park/Atlanta
Norcross, GA 30092 USA
Tel: + 1 770 449 5555

KAWNEER
AN ARCONIC COMPANY

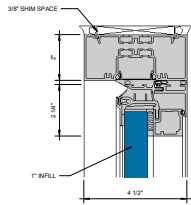

① HEAD CASEMENT OUTSWING
6" = 1'-0"

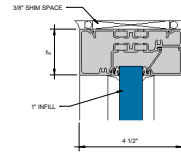

② HEAD
6" = 1'-0"

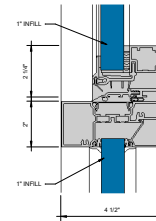

③ CASEMENT OUTSWING
6" = 1'-0"

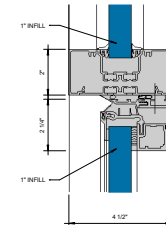

④ PROJECT OUT
6" = 1'-0"

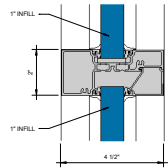

⑤ HORIZONTAL
6" = 1'-0"

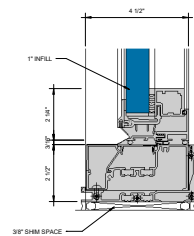

⑥ PROJECT-OUT-SILL WITH SEALANT
OPTION
6" = 1'-0"

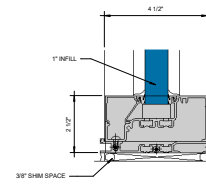

⑦ SILL WITH SEALANT OPTION
6" = 1'-0"

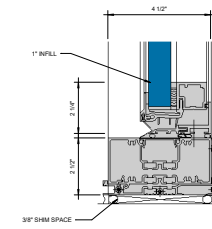

⑧ PROJECT-OUT-SILL WITH SEALANT
OPTION & SILL FILLER CLIP
6" = 1'-0"

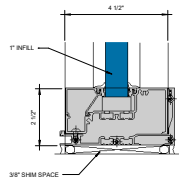

⑨ SILL WITH SEALANT & GASKET OPTION
6" = 1'-0"

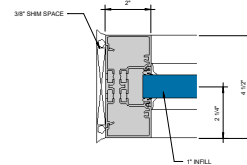

⑩ JAMB
6" = 1'-0"

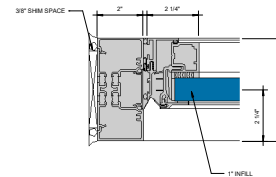

⑪ CASEMENT OUTSWING
6" = 1'-0"

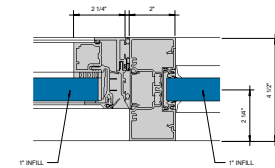

⑫ CASEMENT OUTSWING
6" = 1'-0"

Kawneer

Trifab™ 451UT Framing System - GLASSvent UT Windows Details - Center Set - Inside Glazed - 1" Infill

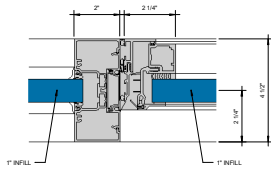

① PROJECT OUT
Ø = 1'-0"

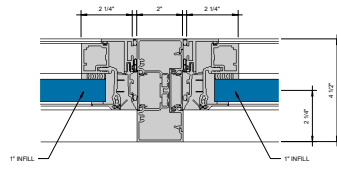

② PROJECT OUT
Ø = 1'-0"

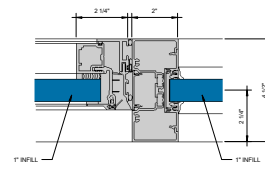

③ PROJECT OUT
Ø = 1'-0"

KAWNEER AN ARCONIC COMPANY

555 Guthridge Ct.
Technology Park/Atlanta
Norcross, GA 30092 USA
Tel: + 1 770 449 5555

KAWNEER
AN ARCONIC COMPANY

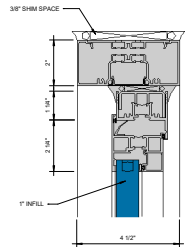

① WINDOW HEAD AT HEAD
Ø = 1'-0"

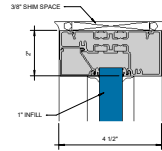

② HEAD
Ø = 1'-0"

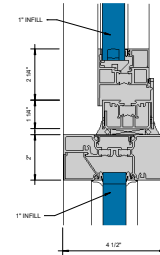

③ WINDOW SILL AT HORIZONTAL
Ø = 1'-0"

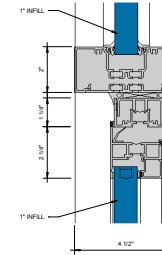

④ WINDOW HEAD AT HORIZONTAL
Ø = 1'-0"

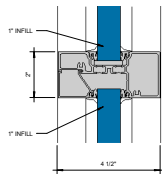

⑤ HORIZONTAL
Ø = 1'-0"

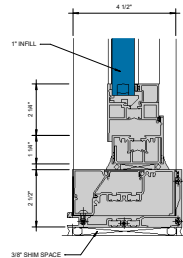

⑥ WINDOW SILL AT SILL WITH SEALANT
OPTION
Ø = 1'-0"

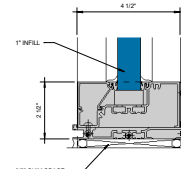

⑦ SILL WITH SEALANT OPTION
Ø = 1'-0"

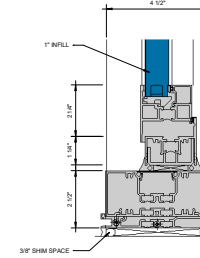

⑧ WINDOW SILL AT SILL WITH SEALANT
OPTION & SILL FILLER CUP
Ø = 1'-0"

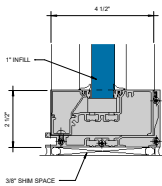

⑨ SILL WITH SEALANT & GASKET OPTION
Ø = 1'-0"

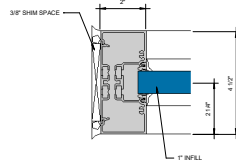

⑩ JAMB
Ø = 1'-0"

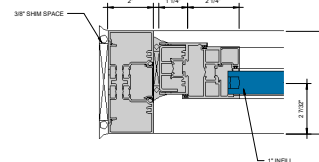

⑪ JAMB
Ø = 1'-0"

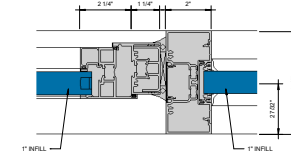

⑫ VERTICAL MULLION
Ø = 1'-0"

KAWNEER AN ARCONIC COMPANY

555 Guthridge Ct.
Technology Park/Atlanta
Norcross, GA 30092 USA
Tel: +1 770 449 5555

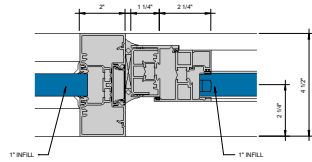

① VERTICAL MULLION
S=1-10

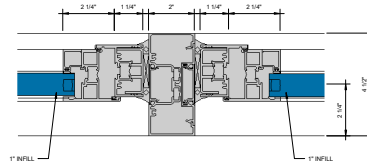

② VERTICAL MULLION
S=1-10

Kawneer

Trifab™ 451UT Framing System -8225TL Thermal Windows Details - Center Set - Outside Glazed - Optional Glass Stops “Up” - 1" Infill

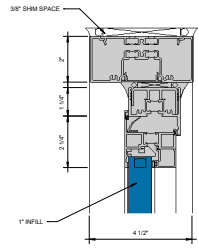

① WINDOW HEAD AT HEAD
Ø = 1'-0"

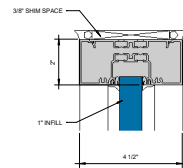

② HEAD
Ø = 1'-0"

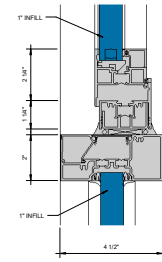

③ WINDOW SILL AT HORIZONTAL
Ø = 1'-0"

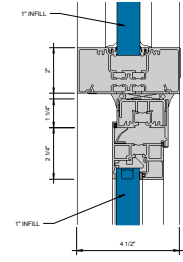

④ WINDOW HEAD AT HORIZONTAL
Ø = 1'-0"

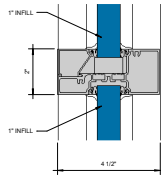

⑤ HORIZONTAL
Ø = 1'-0"

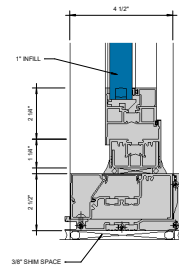

⑥ WINDOW SILL AT SILL WITH SEALANT
OPTION
Ø = 1'-0"

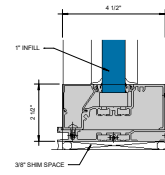

⑦ SILL WITH SEALANT OPTION
Ø = 1'-0"

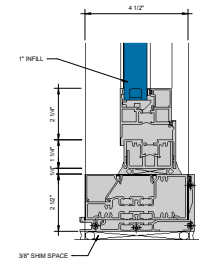

⑧ WINDOW SILL AT SILL WITH SEALANT
OPTION & SILL FILLER CLIP
Ø = 1'-0"

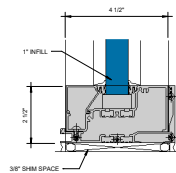

⑨ SILL WITH SEALANT & GASKET OPTION
Ø = 1'-0"

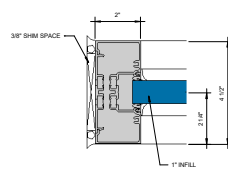

⑩ JAMB
Ø = 1'-0"

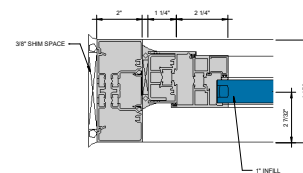

⑪ JAMB
Ø = 1'-0"

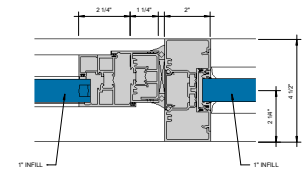

⑫ VERTICAL MULLION
Ø = 1'-0"

KAWNEER AN ARCONIC COMPANY

555 Guthridge Ct.
Technology Park/Atlanta
Norcross, GA 30092 USA
Tel: +1 770 449 5555



Kawneer

Trifab™ 451UT Framing System -8225TL Thermal Windows Details - Center Set - Outside Glazed - Optional Glass Stops “Up” - 1" Infill

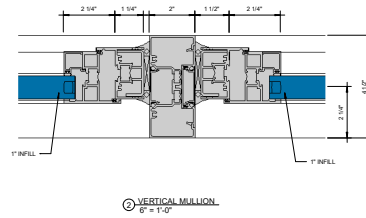
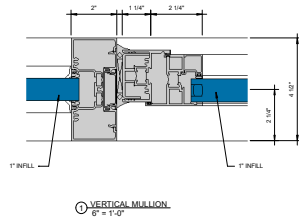

KAWNEER AN ARCONIC COMPANY

555 Guthridge Ct.
Technology Park/Atlanta
Norcross, GA 30092 USA
Tel: + 1 770 449 5555

KAWNEER
AN ARCONIC COMPANY

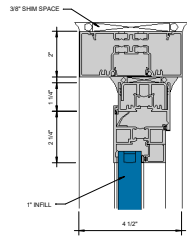

1 WINDOW HEAD AT HEAD
6" = 1'-0"

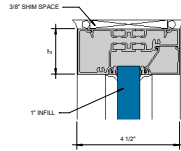

2 HEAD
6" = 1'-0"

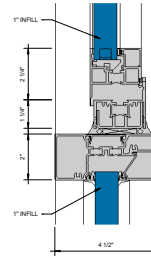

3 WINDOW SILL AT HORIZONTAL
6" = 1'-0"

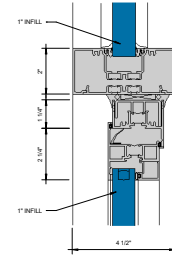

4 WINDOW HEAD AT HORIZONTAL
6" = 1'-0"

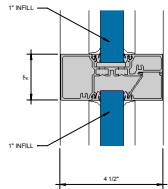

5 HORIZONTAL
6" = 1'-0"

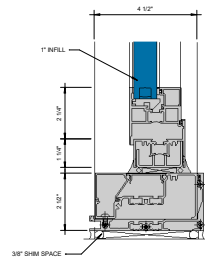

6 WINDOW SILL AT SILL WITH SEALANT
OPTION
6" = 1'-0"

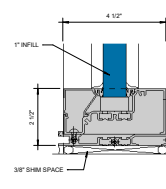

7 SILL WITH SEALANT OPTION
6" = 1'-0"

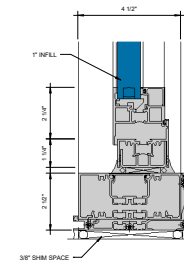

8 WINDOW SILL AT SILL WITH SEALANT
OPTION & SILL FILLER CLIP
6" = 1'-0"

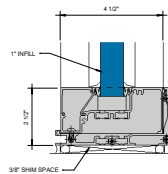

9 SILL WITH SEALANT & GASKET OPTION
6" = 1'-0"

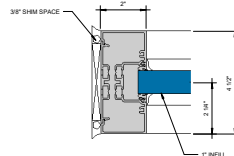

10 JAMB
6" = 1'-0"

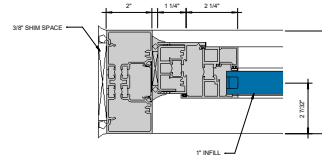

11 JAMB
6" = 1'-0"

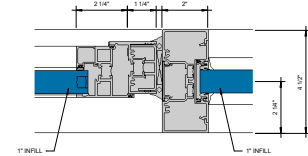

12 VERTICAL MULLION
6" = 1'-0"

KAWNEER AN ARCONIC COMPANY

555 Guthridge Ct.
Technology Park/Atlanta
Norcross, GA 30092 USA
Tel: +1 770 449 5555

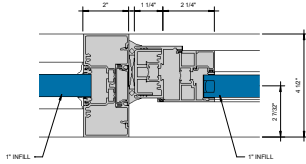

① VERTICAL MULLION
Ø = 1.0"

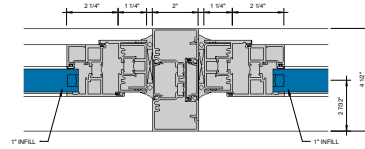

① VERTICAL MULLION
Ø = 1.0"

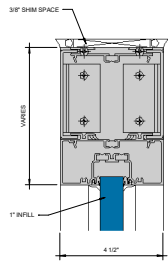

Ⓒ BRAKE METAL ADAPTER OUTSIDE
GLAZED HEAD
6" = 1'-0"

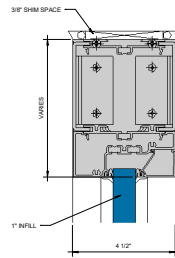

Ⓒ BRAKE METAL ADAPTER INSIDE
GLAZED HEAD
6" = 1'-0"

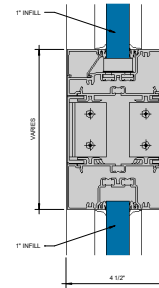

Ⓒ BRAKE METAL ADAPTER OUTSIDE
GLAZED HORIZONTAL
6" = 1'-0"

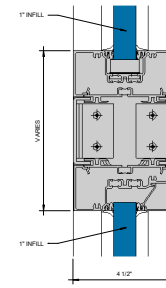

Ⓒ BRAKE METAL ADAPTER INSIDE
GLAZED HORIZONTAL
6" = 1'-0"

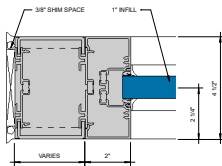

Ⓒ BRAKE METAL ADAPTER JAMB
6" = 1'-0"

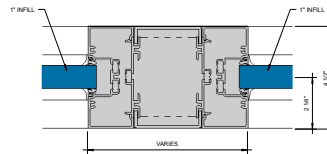

Ⓒ BRAKE METAL ADAPTER VERTICAL
6" = 1'-0"

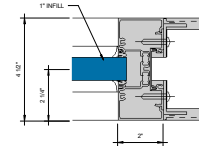

Ⓒ TOP VIEW BRAKE METAL ADAPTER
6" = 1'-0"